

**Overall notes**

- (A) Please refer to separate detailed guidance SPD Doc 03 - relating to the East West Link Road corridor & Main Centre (by AECOM). See Masterplan weblink [www.preston.gov.uk/masterplan](http://www.preston.gov.uk/masterplan)
- (B) Please note that this masterplan framework should be seen as a long term **indicative** vision (over 20+ years). The plan(s) will therefore be subject to periodic review, change and refinement over the long term.

**Map notes/labels:**

- 1 Note recommended 60m buffer suggested to either side of electricity pylon corridors (see details page 14)
- 2 Potential alternative location of local (village) centre and small scale residential development (see note A above).
- 3 Potential alternative location of secondary school and playing fields (detail TBC).
- 4 Main Centre - also refer to separate guidance (see note A above).
- 5 Preston Grasshoppers site - potentially retained and enhanced (including improved connections).
- 6 Potential additional small scale mixed use local centre - Hollins "Eastway Hub" site.

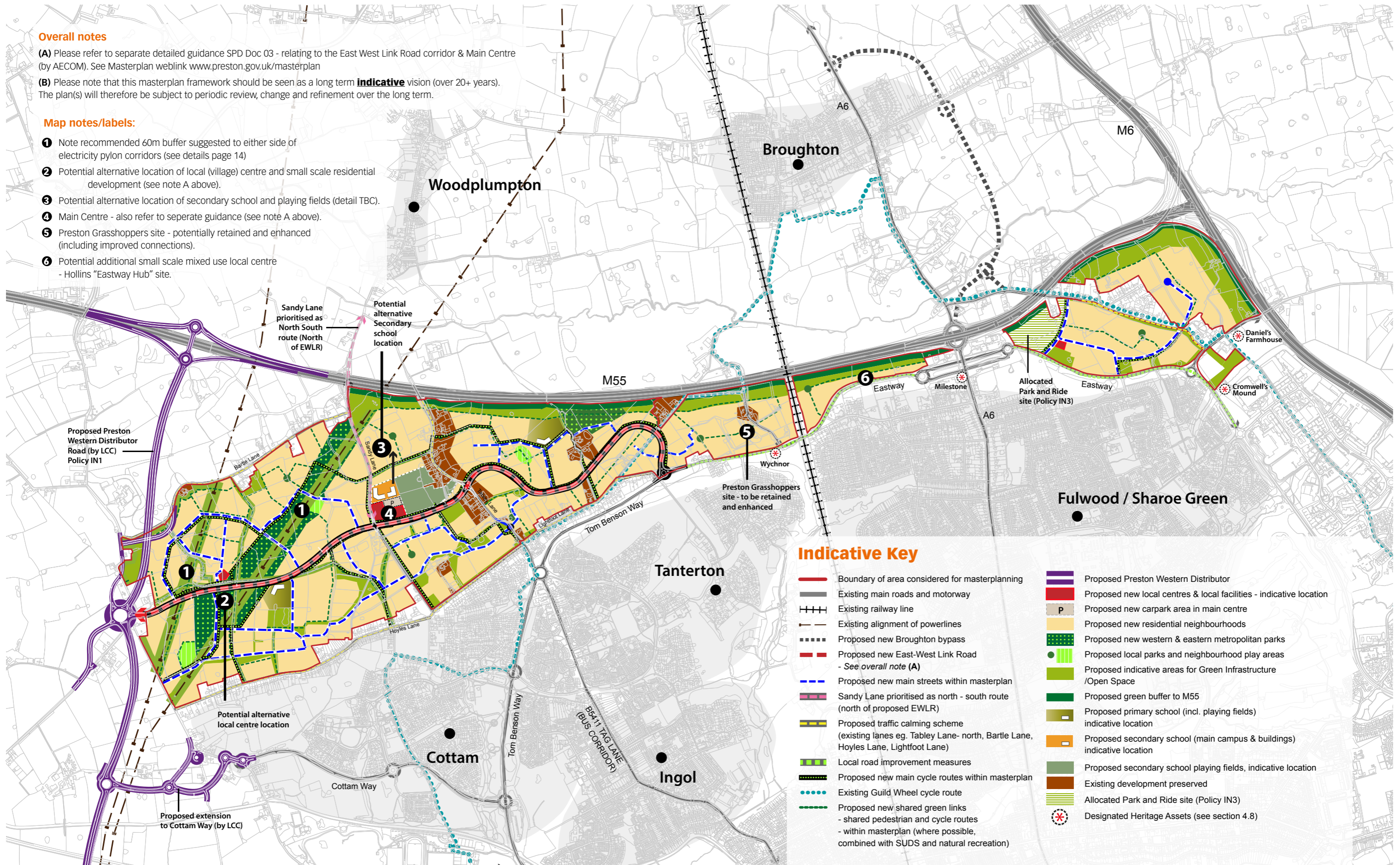

**Indicative Key**

- Boundary of area considered for masterplanning
- Existing main roads and motorway
- Existing railway line
- Existing alignment of powerlines
- Proposed new Broughton bypass
- Proposed new East-West Link Road - See overall note (A)
- Proposed new main streets within masterplan
- Sandy Lane prioritised as north - south route (north of proposed EWLR)
- Proposed traffic calming scheme (existing lanes eg. Tabley Lane- north, Bartle Lane, Hoyles Lane, Lightfoot Lane)
- Local road improvement measures
- Proposed new main cycle routes within masterplan
- Existing Guild Wheel cycle route
- Proposed new shared green links - shared pedestrian and cycle routes - within masterplan (where possible, combined with SUDS and natural recreation)
- Proposed Preston Western Distributor
- Proposed new local centres & local facilities - indicative location
- Proposed new carpark area in main centre
- Proposed new residential neighbourhoods
- Proposed new western & eastern metropolitan parks
- Proposed local parks and neighbourhood play areas
- Proposed indicative areas for Green Infrastructure /Open Space
- Proposed green buffer to M55
- Proposed primary school (incl. playing fields) indicative location
- Proposed secondary school (main campus & buildings) indicative location
- Proposed secondary school playing fields, indicative location
- Existing development preserved
- Allocated Park and Ride site (Policy IN3)
- Designated Heritage Assets (see section 4.8)

**MAP 05 - Main Masterplan indicative framework (March 2017)**

