

ORDNANCE SURVEY

PLAN SD 5239 & PLAN SD 5339

PARCEL NUMBERS AND ACREAGES
The number and acreage of each parcel of land is shown within the parcel. It is important when identifying a parcel to specify the number(s) of the plan(s) on which it falls.
IN PARCELS DIVIDED BY THE SHEET EDGE, THE ACREAGES ARE SHOWN TO SHEET EDGE ONLY.

Revised July 1965
Levelled 1961

Scale: 1:2500 or 25.344 inches to 1 mile

Revised July 1965
Levelled 1961

The West half of this sheet is Plan SD 5239
The East half of this sheet is Plan SD 5339

PLAN SD 5239 & PLAN SD 5339

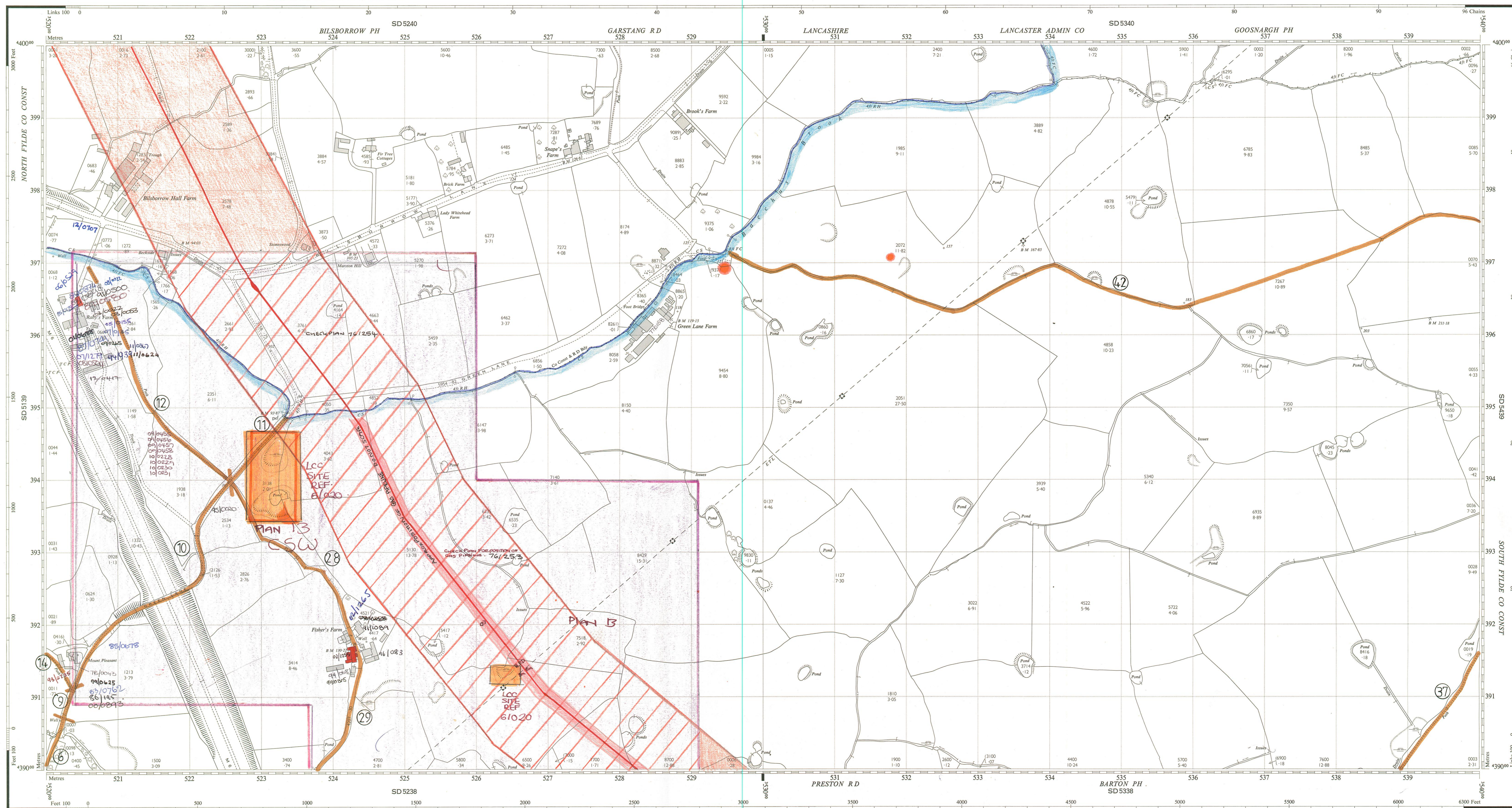

Made and published by the Director General of the Ordnance Survey, Chessington, Surrey, 1966.
Reconstituted from former County Series plans 1960. Last revised 1965.

© Crown Copyright 1966.

E6

The West half of this sheet is Plan SD 5239
The East half of this sheet is Plan SD 5339

- Antiquities (site of)
- Change of boundary meeting
- Limit of area within which the acreages of individual parcels are not shown
- Leveling Information: Bench Mark lists, containing fuller and possibly later leveling information, are obtainable from the Director General, Ordnance Survey.
- Boundary Mering Abbreviations: Base of Bank (BB), Centre of Bank (CB), Centre of Canal, etc. (CC), Centre of Drain, etc. (CD), Centre of Covered Stream (CCS), Bench Mark (BM), Fundamental (F), Parcels joined for acreages, Levelling Information, Altitudes of Bench Marks and Surface Levels are given in feet above the Newlyn Datum.
- Face of Wall (FW), Side of Road, etc. (SR), Track of Hedge (TH), Track of Stream (TS), Defaced, Undeline (DF/UD)

REFERENCE

For fuller information see Reference Card published separately.

NATIONAL GRID REFERENCE
The lines on the plan form part of the National Grid and are spaced at 100 metre intervals. To give a large scale reference defining the position of a point to the nearest 10 metres proceed as follows—

EXAMPLE: F in Fisher's Farm

EASTING	NORTHING
Take west edge of square in which point lies and read the figures opposite this line on NORTH and SOUTH margins	Take south edge of square in which point lies and read the figures opposite this line on EAST and WEST margins
Estimate tens of metres from the grid line	Estimate tens of metres from the grid line
527	391
527	391

TEN METRE REFERENCE: SD 5273919

For fuller information see "The Projection for Ordnance Survey Maps and Plans and the National Reference System".
The representation on this plan of a road, track or path is no evidence of the existence of a right of way.
A square such as this plan represents 1/16th of an acre on the ground.
The altitudes of towers when shown is approximate.

- Beer House (BH), Bench Mark (BM), Boundary Post (BP), Boundary Stone (BS), Capstan (Ca), Crane (C), Drinking Fountain (DF), Electricity Pillar or Post (EP), Electricity Transmission Line (ETL), Fire Alarm Pillar (FAP), Flagstaff (FS), Foot Bridge (FB), Fundamental Bench Mark (FBM), Mean High or Low Water (MHW or MLLW), Guide Post (GP), Letter Box (LB), Level Crossing (LC), Loading Gauge (LG), Mail Pickup (MPU), Mile, or Mooring Post (MP), Mile Stone (MS), Pillar, Pole or Post (P), Police Call Box (PCB), Post Office Telephone Pillar (PTP), Post Office Telephone (PO), Public House (PH), Pump (Pp), Revision Point (RP), Signal Box, or Post (SB, SP), Signal Bridge (SBr), Springs (Spr), Stone (St), Sundial (SD), Tank or Track (TK), Telephone Call Box (TCB), Traverse Station (TS), Water Point, or Tap (Wp, Pt, Wp, T), Weighbridge (WB), Well (W), Wind Pump (WP), Mean High or Low Water Springs (MHS or MLLWS)

PARCEL NUMBERS AND ACREAGES
The number and acreage of each parcel of land is shown within the parcel. It is important when identifying a parcel to specify the number(s) of the plan(s) on which it falls.
IN PARCELS DIVIDED BY THE SHEET EDGE, THE ACREAGES ARE SHOWN TO SHEET EDGE ONLY.

PLAN SD 5239 & PLAN SD 5339